



致: 全体师生、家长

2022 年开学事宜 (更新)

因 Omicron 疫情来势汹汹, 全国基本传染数攀升, 故我校 1 月 10 日开学时, 各级上课安排有所调整:

	实体课	网课	备注
第一周 (10/1-14/1)	初二、初三及高三级 (宿舍生于 9/1, 9am-2pm 返校)	初一、高一及高二级	初一级网课时间为: 3:30pm-4:55pm
第二周 (17/1-21/1)	高一、高二及高三级 (宿舍生于 16/1, 9am-2pm 返校)	初一、初二及初三级	17/1 全校师生参与 始业式, 时间: 2:00pm-3.45pm 18/1 大宝森节假日
第三周 (24/1-28/1)	初二、初三及高三级	初一、高一及高二级	
第四周 (31/1-4/2)	农历新年假期		
第五周 7/2-11/2	高一、高二及高三级	初一、初二及初三级	9/2 特假
第六周 (14/2-18/2)	初二、初三及高三级	初一、高一及高二级	
第七周 (21/2-25/2)	高一、高二及高三级	初一、初二及初三级	

2. 开课请同学仔细查阅上课表, 按指定的日期返校/线上上课。课表与 Class code 将于开学前透过电邮发送至学生个人邮箱, 请同学于 1 月 8 日查收。

3. 返校当日, 学生需自行在家做检测, 请预购 RTK 检测试剂。返校当天将有检测结果的试剂携带到校, 以供检查 (请用透明胶袋密封), 检测结果呈阴性方可入校。





濱華中學 PIN HWA HIGH SCHOOL

4. 联课活动将从第二周开始（第一周暂停）展开实体课，居家线上上课暂停。学会固定额外活动先不展开，直到另行通知。体育校队课程安排，请依体育处发布之安排为准。

5. 学生若有需要租借电脑，以供上网课之用可联系资讯处主任，请 Email 洽询：
teesawbee@smpinhwa.edu.my。

疫情当下，吁同学返校需严守防疫 SOP，配合校园安全管理，让我们共同打造一个健康安全校园。新学年、新希望，盼大家安全返校，展开新学年学习之旅。

校长室 启





To: All Teachers, Students and Parents

RE: SCHOOL OPENING OF 2022 NEW ACADEMIC YEAR NOTICE (REVISED)

Concerning to the Omicron variant and the increase in the number of the positive COVID-19 cases across the nation, the classes will be adjusted to the specific arrangement as below when the school starts on 10th January 2022:

	In-Person Classes	Online Classes	Remarks
First Week (10/1-14/1)	Junior 2, 3 and Senior 3 (Hostel students check in to hostel on 9/1 between 9am to 2pm)	Junior 1 and Senior 1, 2	Online classes for Junior 1: 3:30pm-4:55pm
Second Week (17/1-21/1)	Senior 1, 2 and Senior 3 (Hostel students check in to hostel on 16/1 between 9am to 2pm)	Junior 1, 2 and Junior 3	All teachers and students will need to participate the Commencement Ceremony on 17/1, time: 2:00pm-3.45pm 18/1 Thaipusam Holiday
Third Week (24/1-28/1)	Junior 2, 3 and Senior 3	Junior 1 and Senior 1, 2	
Fourth Week (31/1-4/2)	Chinese New Year Holiday		
Fifth Week (7/2-11/2)	Senior 1, 2 and Senior 3	Junior 1, 2 and Junior 3	9/2 Special Holiday
Sixth Week (14/2-18/2)	Junior 2, 3 and Senior 3	Junior 1 and Senior 1, 2	
Seventh Week (21/2-25/2)	Senior 1, 2 and Senior 3	Junior 1, 2 and Junior 3	





濱華中學 PIN HWA HIGH SCHOOL

2. Students are requested to check the above table carefully and return to school for in-person classes or attend online classes according to the specific date. The class schedule and class code will be email to the students before the opening of school, students are requested to check their mailbox on 8th Jan 2022.
3. Students are requested to do the RTK Antigen test at home on the actual day of returning to school and students are requested to bring the test kit sealed in the plastic bag to school for checking. Students with negative RTK test result are allowed to return to school.
4. Co-curricular activities will start from the second week. The students who attend in-person classes at school are required physically participate co-curricular activities. Students who are scheduled to study from home for online classes do not need to participate co-curricular activities. No extra co-curricular activities until further notice. As for the sport teams training, please refer to the arrangement which to be announced by the Sports Department.
5. Students who need to rent a computer for online classes, please contact the Head of Department of ICT through email: teesawbee@smpinhwa.edu.my.

During this pandemic period, students are urged to obey the school pandemic prevention SOPs strictly. Let us work together to build a safe learning environment. Hoping everyone return to school safely, embark on a new learning journey in the new academic year.

The Principal's Office



2022年光前楼教室配置图（上学时段楼梯使用）



请以下班级使用此楼梯上下：
S1S3 S1C1 S1C2 S1C6
S1C7 S1C8 J313 J314
J315 J324 J325 J326

请以下班级使用此楼梯上下：
S1S1 S1S2 S1C3 S1C4
S1C5 S1C9 J311 J312
J321 J322 J323 J327

2022年光前楼教室配置图（放学时段楼梯使用）

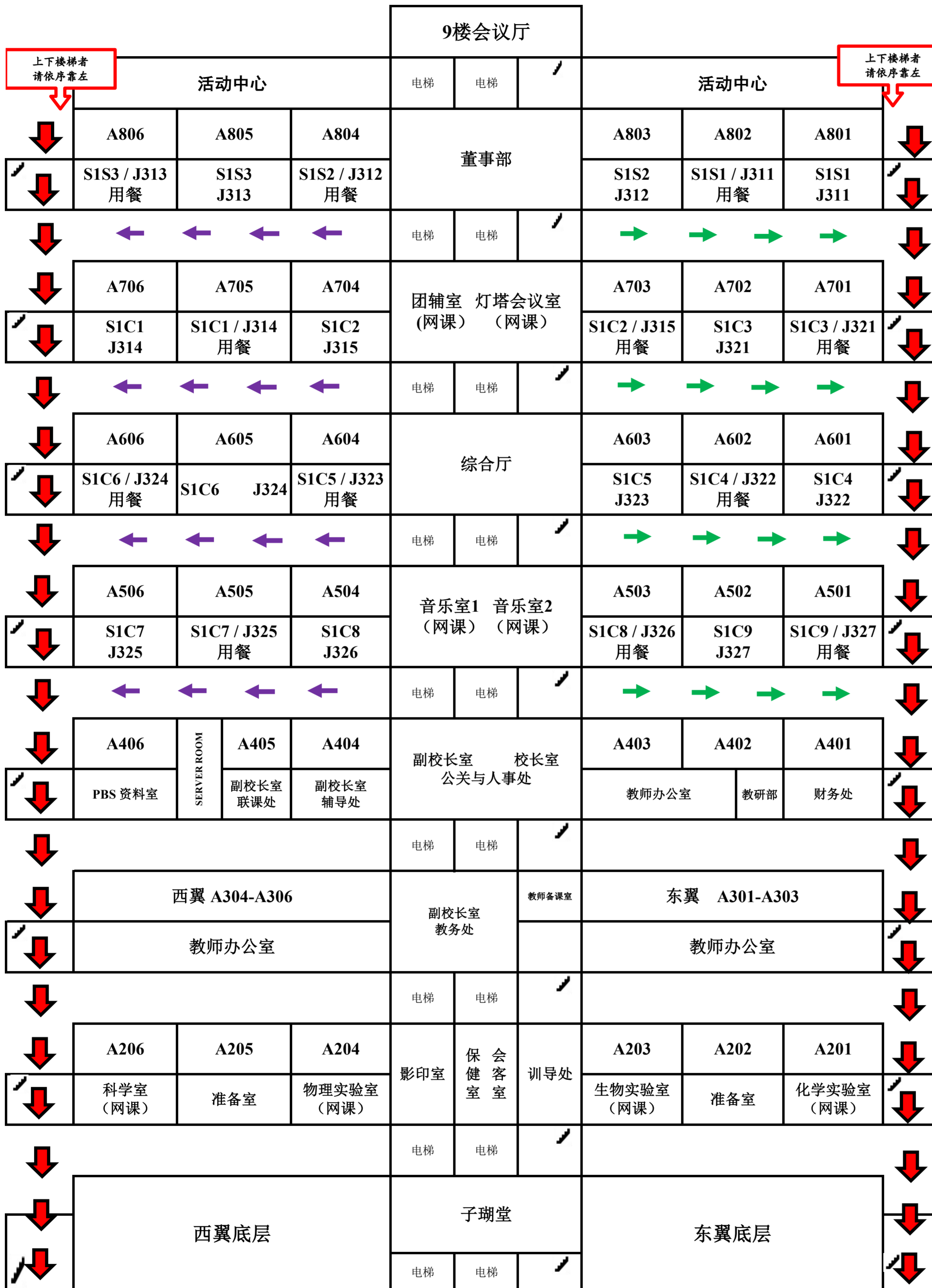

下

下

2022年松木楼教室配置图（上学时段楼梯使用）



2022年教学楼教室配置图（上学时段楼梯使用）

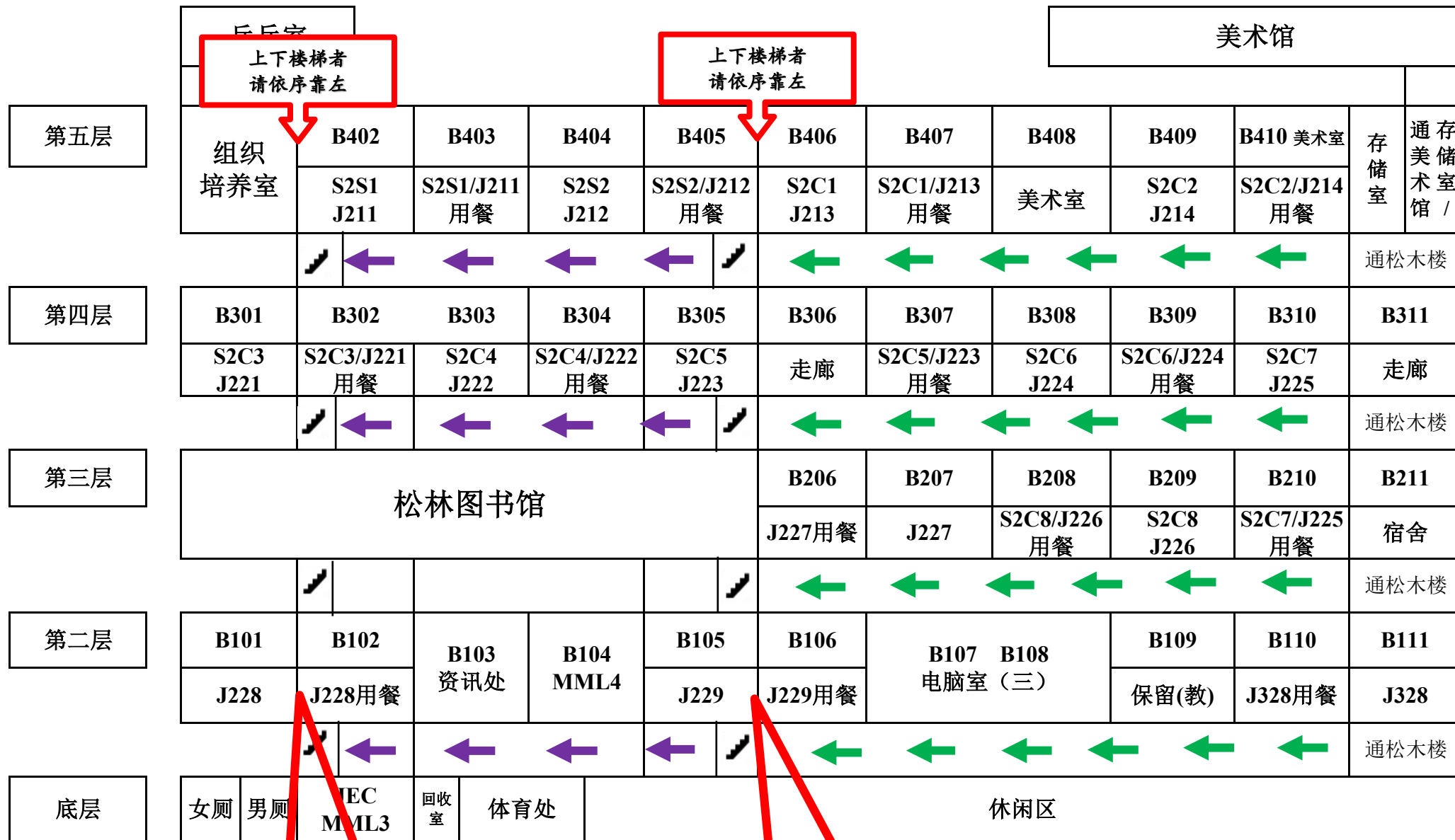

请以下班级使用此楼梯上下：
 S2S1 S2S2 S2C3 S2C4
 S2C5 J211 J212 J221
 J222 J223 J228 J229

请以下班级使用此楼梯上下：
 S2C1 S2C2 S2C6 S2C7
 S2C8 J213 J214 J224
 J225 J226 J227 J328

2022年教学楼教室配置图（放学时段楼梯使用）

